



PentaClad™

Product Data Sheet

Polycarbonate Cladding Systems



Product Specifications



- A Pentaglas® glazing panel
- B Double-tooth panel connector
- C Stainless steel panel clip
- D Aluminum purlin substructure
- E Aluminum framing system

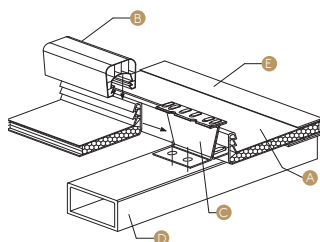

Product Specifications

Glazing	Pentaglas® translucent polycarbonate panel with Nano-Cell® extrusion
Thickness:	10 mm, 12 mm, or 16 mm
Width:	2 ft nominal (23 5/8 in) (600 mm)
Length:	Up to 40 ft long
Panel Weight:	12 mm = 0.53 lb/ft ² 16 mm = 0.70 lb/ft ²
Panel Joint:	Mechanically interlocking double-tooth connection
Color Options:	Standard - clear, white, ice white, blue, green, bronze, refl. gray
Note: all colors are available with a matte finish upon request - consult for other available color options	

Glazing Extrusion



Our Pentaglas® translucent glazing is precision engineered with Nano-Cell® technology. This specialized panel extrusion results in the cells measuring smaller than 0.18 inches, providing the panel with superior durability and prolonged resistance to impact. The unique cell structure significantly improves the quality and balanced distribution of glare-free natural light. Pentaglas glazing panels are co-extruded with a specialized UV inhibitor on both sides of the panel.

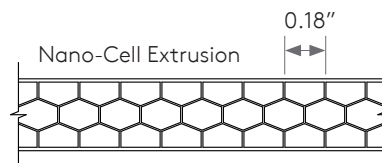

— VS. —

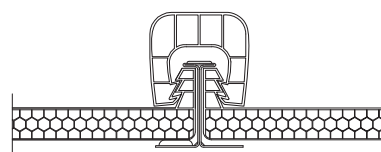
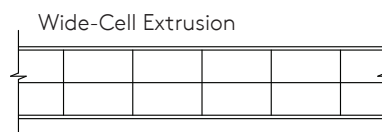

Double-Tooth Connection

The double-tooth edge on the upstands of the glazing panels enables the system to withstand extremely high loads without concern for the panels disengaging. As the panels deflect, their grip on the u-shaped panel connector actually strengthens, ensuring long-term performance under loading conditions.

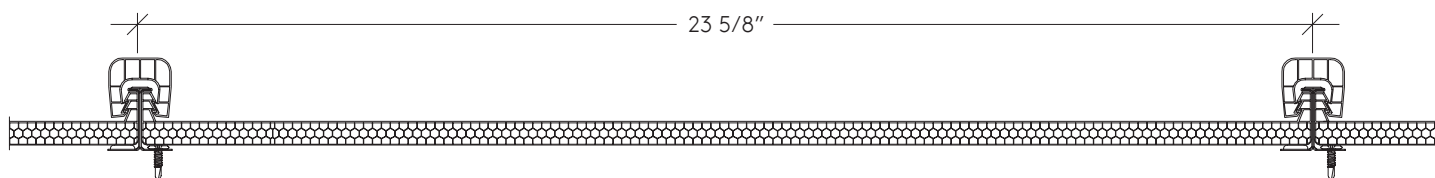

10, 12, & 16 mm

Testing/Performance

Test Description	Test Procedure	Results & Comments
Code Compliance, IBC	ASTM D635, D1929, D2843, E84 per ESR-4745	CC1
Uniform Load Structural / Span	ASTM E330	Up to ±105psf. Consult KLA for job specific span capabilities
High Velocity Hurricane Zone (HVHZ)	TAS 202, 203	Up to ±105psf. Consult KLA for job specific span capabilities
Concentrated Load 1 sqf Area		No damage - 800 lbs
Water Penetration	AAMA 501.2	No penetration

**Spanning capabilities are dependent on project specific design loads, which are determined based on several different factors, including location on the building, height above ground, wind speed, etc.*

Note: Pentaglas glazing panels come in several thicknesses. Please consult Kingspan Light + Air to verify individual test results specific to each panel thickness.

Kingspan Light + Air (KLA) is engaged in continuing research to improve its products. Therefore, the right is reserved to modify or change the data provided in this Technical Summary without notice. This is descriptive literature and does not constitute warranties, expressed or implied. For statement of warranty, contact KLA. The above tests were performed and verified by certified independent third parties. If you have questions on a specific test or product, please contact a KLA Representative. Kingspan Light + Air does not assure compliance with any plans or specifications and it remains the responsibility of the customer to confirm compliance of the product with applicable local, state, and national codes and other laws or regulations.



Kingspan Light + Air

North American Headquarters

28662 N. Ballard Dr.

Lake Forest, IL 60045

Toll Free: +1 800 759 6985

T: +1 847 816 1060

F: +1 847 816 0425

E: info@kingspanlightandair.us

www.kingspanlightandair.us

For the product offering in other markets please
contact your local sales representative or visit
www.kingspan.com/us/en/

Notes

For additional technical information and/or daylighting systems design consultation, contact Kingspan Light + Air for your specific needs. Care has been taken to ensure that the contents of this publication are accurate, but Kingspan Limited and its subsidiary companies do not accept responsibility for errors or for information that is found to be misleading. Suggestions for, or description of, the end use or application of products or methods of working are for information only and Kingspan Limited and its subsidiaries accept no liability in respect thereof.

MKT-PDS-0011-2301

